

# **QT11-W** Wireless Universal Transmitter Sensor

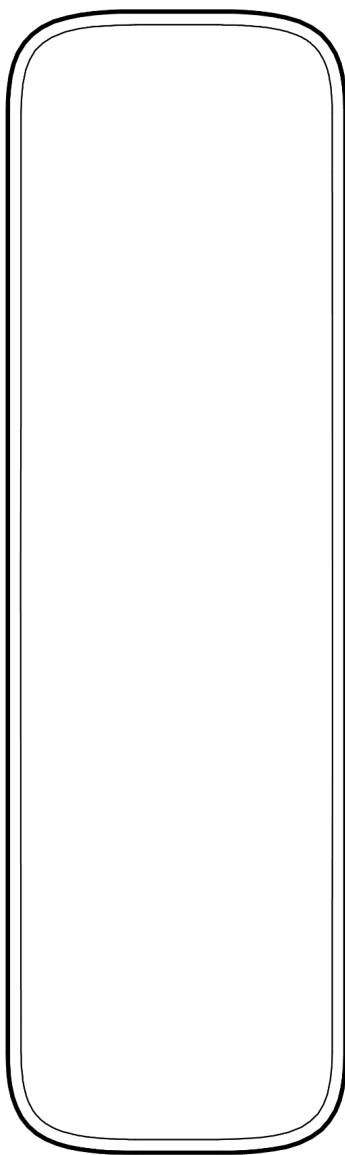

## Document Details

### Version

**V1.0** 20250919

(V1.0 published 20250919)

### Firmware

Firmware version can be verified on Verkada

Command [command.verkada.com](https://command.verkada.com).

### Product Models

This install guide pertains to model QTII-W-HW.

© Copyright 2025 Verkada Inc. All rights reserved.

Verkada and the Verkada logo are registered trademarks or service marks of Verkada Inc. ("Verkada"). All other trademarks are the property of their respective owners.

Verkada may make changes to this document at any time without notice. The information presented herein may be inaccurate or outdated, and Verkada is under no obligation to maintain it. ALL INFORMATION IS PROVIDED "AS-IS" AND WITHOUT ANY WARRANTIES, IMPLIED, EXPRESS, OR OTHERWISE. VERKADA DISCLAIMS LIABILITY FOR ALL DAMAGES, INCLUDING WITHOUT LIMITATION ANY DIRECT, INDIRECT, SPECIAL, INCIDENTAL, PUNITIVE, OR CONSEQUENTIAL DAMAGES, ARISING OUT OF USE OF THIS DOCUMENT.

Any intellectual property rights relating to Verkada products are and shall remain Verkada's exclusive property. Use of any Verkada product is subject to Verkada's end user agreement or other executed agreement with Verkada. No license, either expressed or implied, to use or distribute any Verkada product is granted under this document.

This document may not be sold, resold, licensed or sublicensed and may not be transferred without Verkada's prior written consent. No part of this document may be reproduced in whole or in part without the express written consent of Verkada.



## What's in the Box

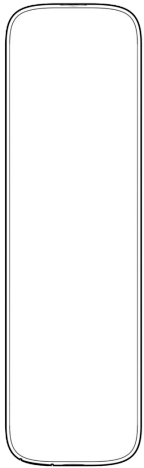

**Transmitter Module**



**Transmitter Mount Plate**  
(Attached to Transmitter)

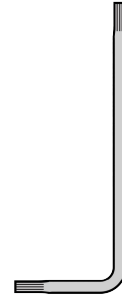

**T10 Security  
Torx L-key**

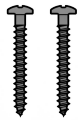

**Wood Screws (2  
pcs)**



**Sheet Metal Screws  
(2 pcs)**

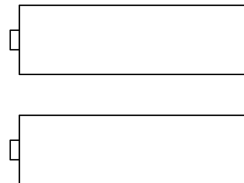

**L91 AA Batteries  
(2 pcs)**

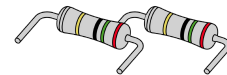

**1kΩ EOL  
Supervision Resistors  
(2 pcs)**

## What you'll need

- Verkada VLink Hub
- A smartphone or laptop
- A working internet connection
- 1/8 inch (3.2mm) drill bit for pilot holes
- #2 Phillips head screwdriver/driver bit
- Wire stripper (for terminal block)
- Flat head screwdriver (for terminal block)
- Two L91 AA Batteries (included)

## Connect

For easy registration and setup, scan the QR code on the product.

If you prefer to manually register your product, please proceed to:

[verkada.com/start](https://verkada.com/start)

## Overview

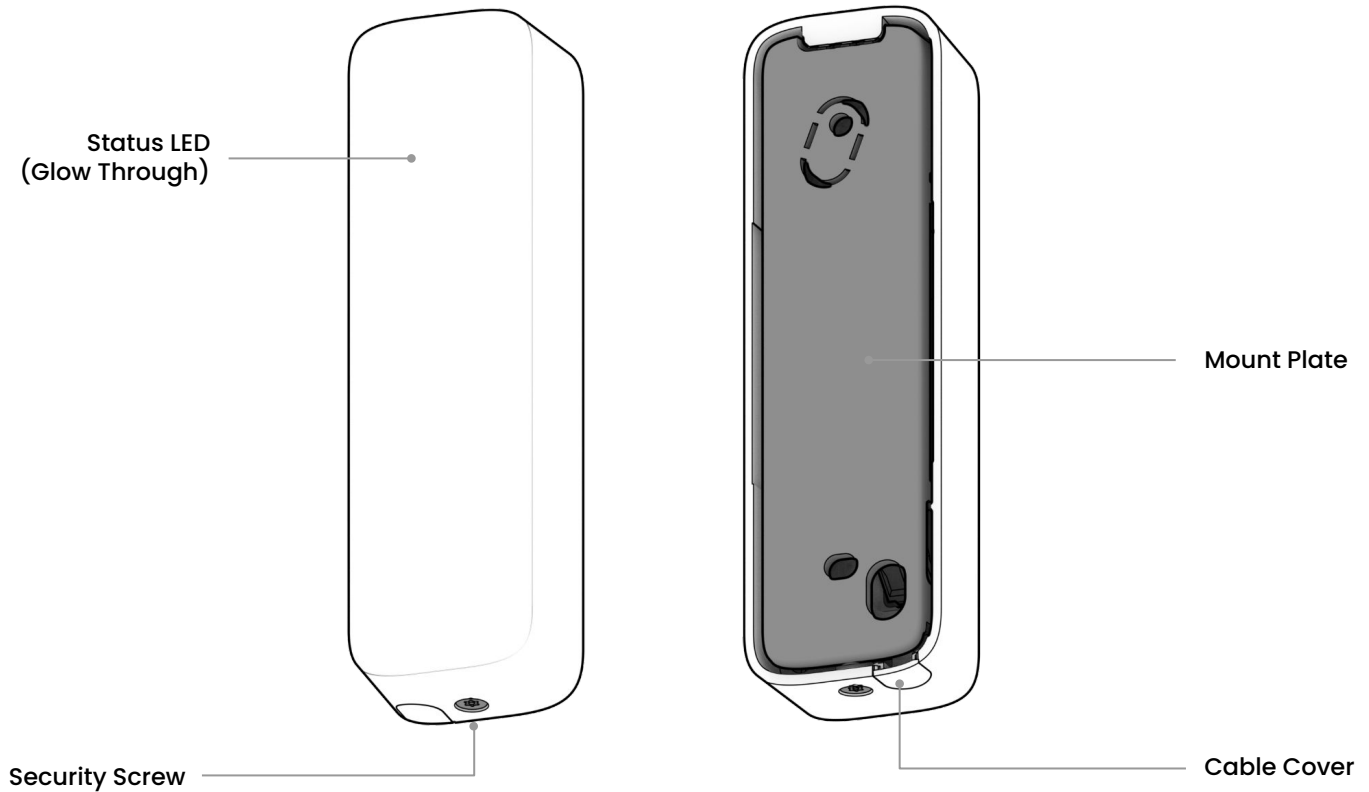

## LED Behaviors

### Install Mode

To enable Install mode, power cycle the device by removing the battery or enable from Command. The LED will remain active for 5 minutes.

- **Solid Green**  
Sensor is detecting a change of state on the input.
- **Blinking Green**  
Sensor is searching for a hub to connect to.
- **Blinking Red**  
Sensor cannot find a hub to connect to.



## Technical Specifications

Battery	2x non-rechargeable Energizer Ultimate Lithium L91 AA batteries (included). <i>*10-year typical battery life.</i>
Connectivity	VLink transceiver with internal antenna (863MHz - 928MHz).
Alarm Input	1x alarm input. Compatible with variable EOL supervision resistors (1k $\Omega$ - 4.7k $\Omega$ ).
RF Range	$\geq$ 2000ft (600m) open field line of sight range when paired with any of Verkada's VLink capable hubs (ex: BP32, BP52, BK22, BE32, WH32, WH52).
Tamper Detection	Yes, breakaway tab.
Dimensions	4.92in (L) x 1.46in (W) x 1.08in (H) / 125mm (L) x 37mm (W) x 27.5mm (H)
Weight	3.5oz / 100g
Operating Temp. & Humidity	32°F-122°F / 0°C-50°C, 0-90% RH non-condensing

## Installation

### Preparation

Use the provided T10 Security Torx L-key to unscrew the security screw at the bottom of the product.

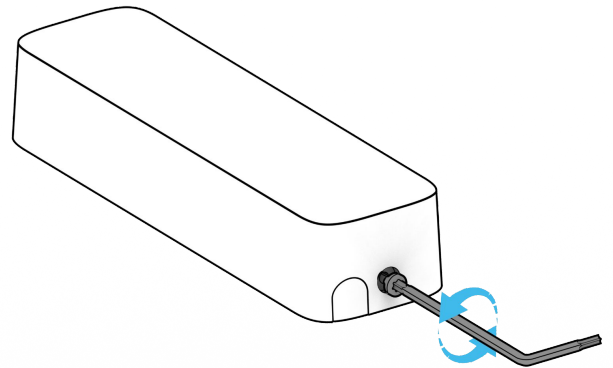

Swing the bottom of the sensor body away from the mount plate and disengage the hook at the top of the sensor mount.

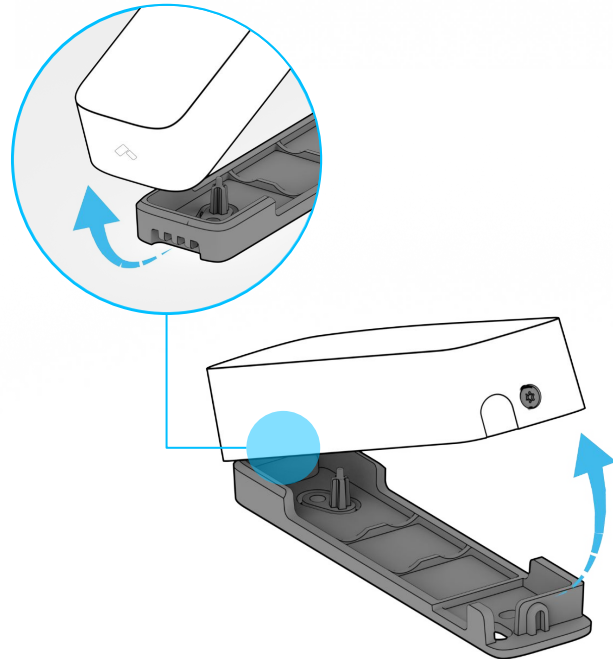

Remove the battery pull tabs.

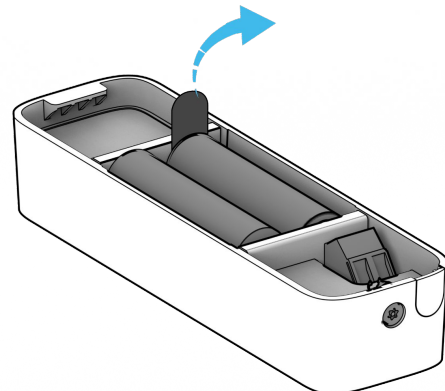

## Installation

### Mounting 1/2

Use a drill to make pilot holes, and screw the mount plate onto the desired surface.

For routing along the surface, remove the cable exit cover from the sensor cover. For routing through the surface, drill a cutout at the cable exit hole.

**Note:** Screw mounting is required for the tamper detection to function. Using only adhesive will disable the feature.

### Cable Routing Options



Along Surface



Through Surface

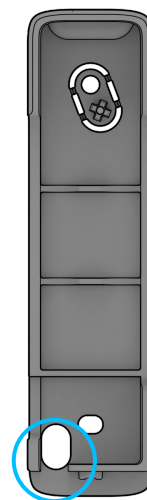
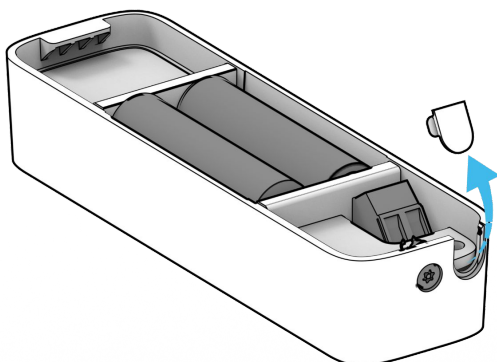

## Installation

### Mounting 2/2

Connect wires to the terminal block using a flathead screwdriver.

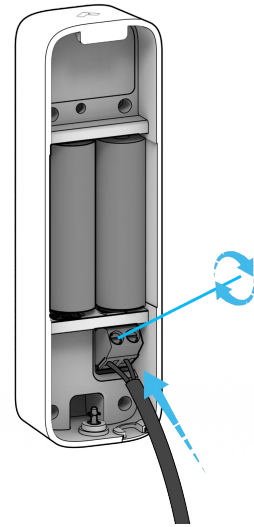

Engage the hook at the top of the sensor mount and swing the sensor module into place.

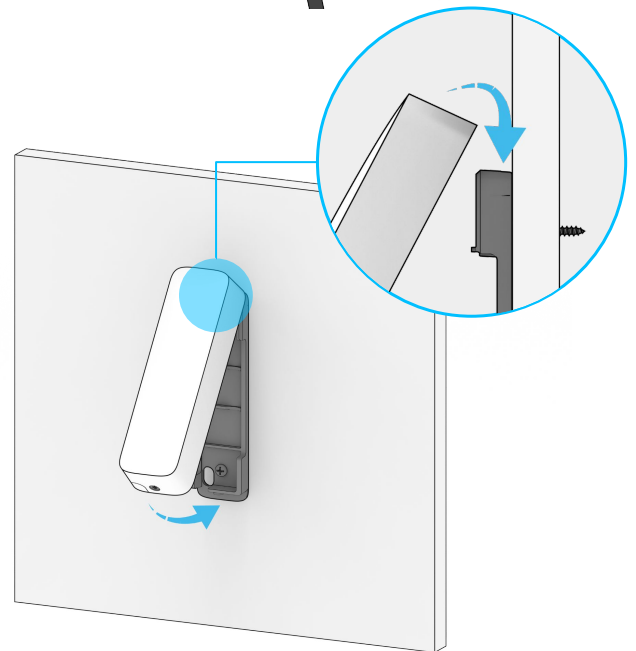

Use the provided T10 Security Torx L-key to secure the security screw in place.

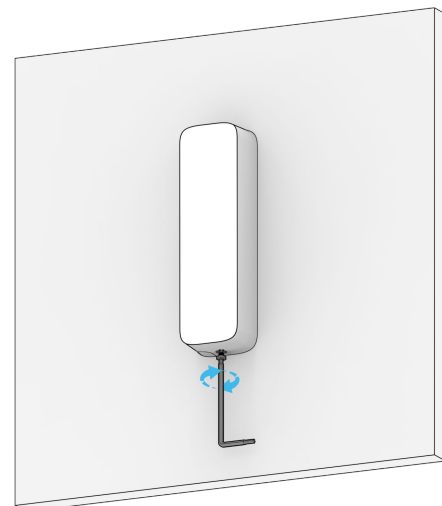

Appendix

## **Support**

Thank you for purchasing this Verkada product. If for any reason you're experiencing issues or need assistance, please contact our 24/7 Technical Support Team immediately.

Sincerely,  
The Verkada Team  
[verkada.com/support](https://verkada.com/support)

