

QM11-W Wireless Wall-Mounted Motion Sensor

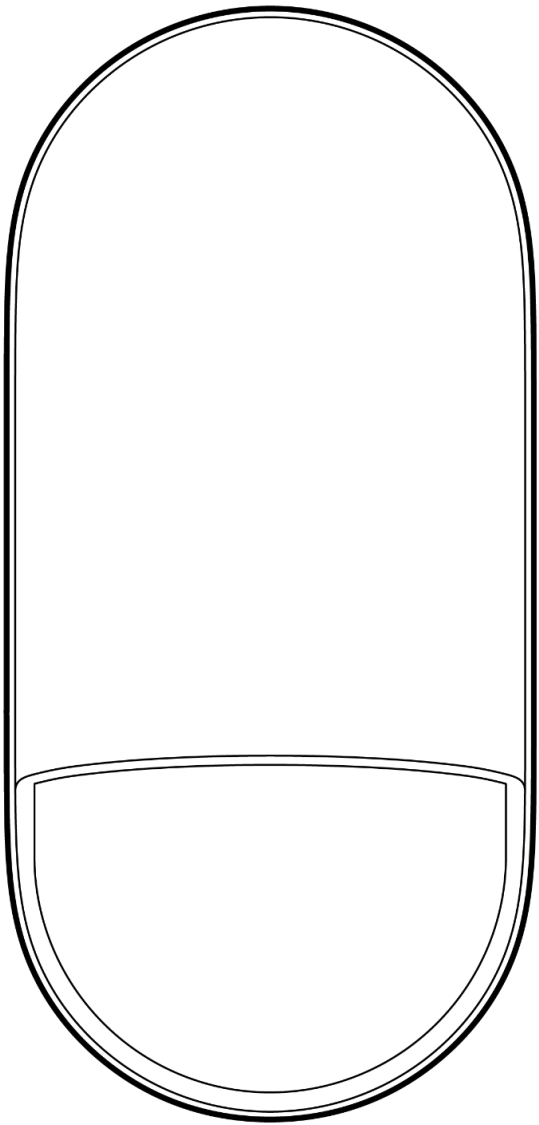

Document Details

Version

V1.0 20250919

(V1.0 published 20250919)

Firmware

Firmware version can be verified on Verkada
Command command.verkada.com.

Product Models

This install guide pertains to model QM11-W-HW.

© Copyright 2025 Verkada Inc. All rights reserved.

Verkada and the Verkada logo are registered trademarks or service marks of Verkada Inc. ("Verkada"). All other trademarks are the property of their respective owners.

Verkada may make changes to this document at any time without notice. The information presented herein may be inaccurate or outdated, and Verkada is under no obligation to maintain it. ALL INFORMATION IS PROVIDED "AS-IS" AND WITHOUT ANY WARRANTIES, IMPLIED, EXPRESS, OR OTHERWISE. VERKADA DISCLAIMS LIABILITY FOR ALL DAMAGES, INCLUDING WITHOUT LIMITATION ANY DIRECT, INDIRECT, SPECIAL, INCIDENTAL, PUNITIVE, OR CONSEQUENTIAL DAMAGES, ARISING OUT OF USE OF THIS DOCUMENT.

Any intellectual property rights relating to Verkada products are and shall remain Verkada's exclusive property. Use of any Verkada product is subject to Verkada's end user agreement or other executed agreement with Verkada. No license, either expressed or implied, to use or distribute any Verkada product is granted under this document.

This document may not be sold, resold, licensed or sublicensed and may not be transferred without Verkada's prior written consent. No part of this document may be reproduced in whole or in part without the express written consent of Verkada.



What's in the Box

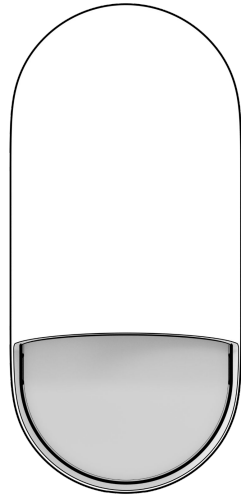

QM11-W

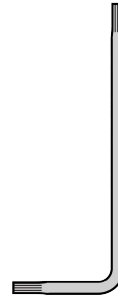

**T10 Security
Torx L-Key**

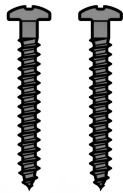

**Wood Screws (2
pcs)**

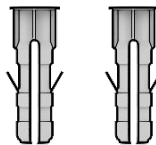

**Wall Anchors
(2 pcs)**

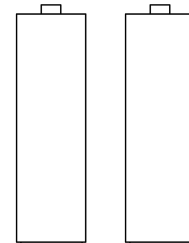

**L91 AA Batteries
(2 pcs)**

What you'll need

- Verkada VLink Hub
- A smartphone or laptop
- A working internet connection
- 1/8 inch (3.2mm) drill bit for pilot holes
- #2 Phillips head screwdriver/driver bit
- Two L91 AA Batteries (included)

Connect

For easy registration and setup, scan the QR code on the product.

If you prefer to manually register your product, please proceed to:

verkada.com/start

Overview

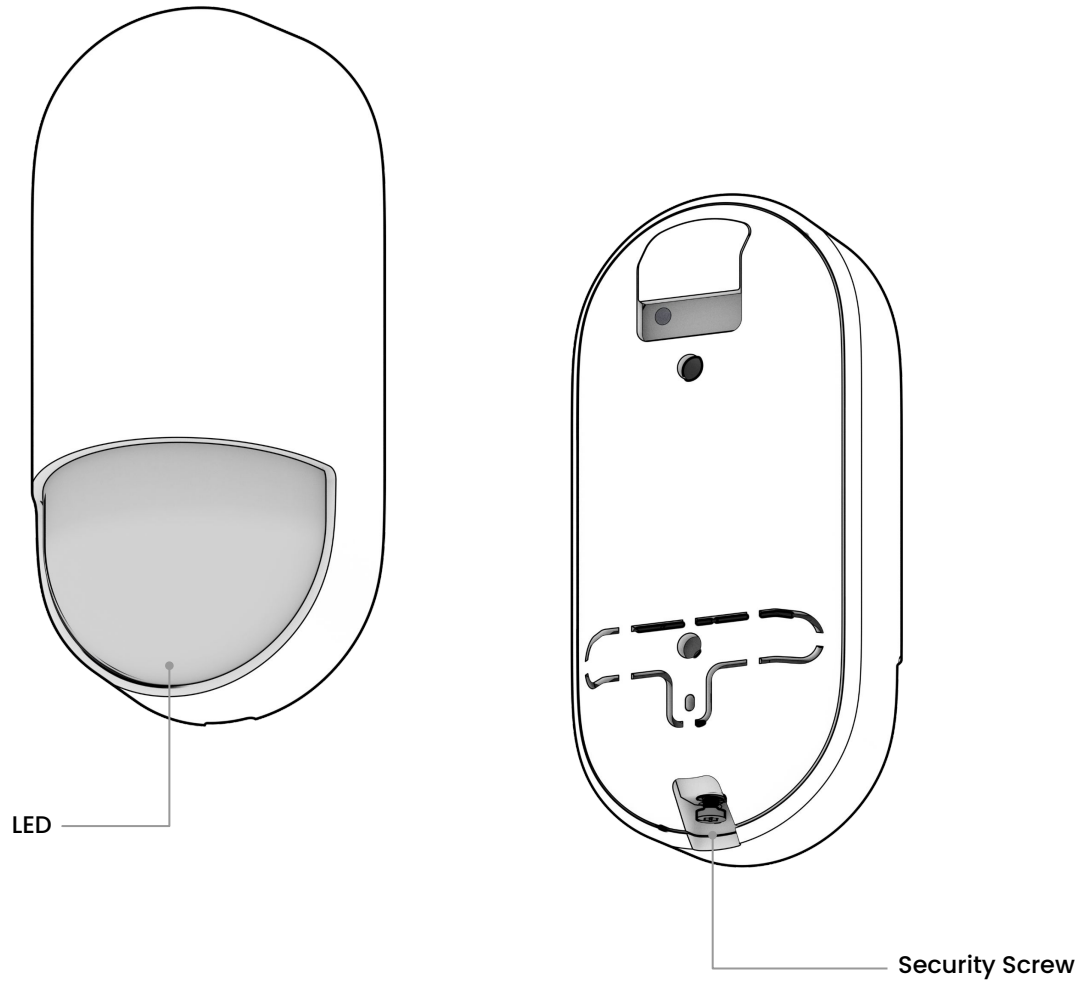

LED Behaviors

Install Mode

To enable Install mode, power cycle the device by removing the battery or enable from Command. The LED will remain active for 5 minutes.

- **Solid Green**
Sensor is detecting motion (PIR and Microwave).
- ☀ **Blinking Green**
Sensor is searching for a hub to connect to.
- ☀ **Blinking Red**
Sensor cannot find a hub to connect to.

Technical Specifications

Battery	2x non-rechargeable Energizer Ultimate Lithium L91 AA batteries (included). <i>*5-year typical battery life.</i>
RF Connectivity	VLink transceiver with internal antenna (863MHz – 928MHz).
RF Range	≥ 2000ft (600m) open field line of sight range when paired with any of Verkada's VLink capable hubs (ex: BP32, BP52, BK22, BE32, WH32, WH52).
Microwave Frequency	X-Band Radar Module operating frequency range (10.52 – 10.53 GHz).
Detection Method	Dual Technology with PIR Sensor and X-Band Microwave Radar.
Detection Range	50ft x 50ft (15m x 15m) with 90 degree FOV.
Movement Detection Speed	1.0 – 8.2 ft/s (0.3 – 2.5m/s)
Tamper Detection	Yes, breakaway tab.
Dimensions	4.72in (L) x 2.25in (W) x 2.03in (H) / 120mm (L) x 57mm (W) x 51.5mm (H)
Weight	5.36oz / 152g
Operating Temp. & Humidity	32°F–122°F / 0°C–50°C, 0–90% RH non-condensing

**Based on 150 motion events a day and the status LED disabled during normal operations.
Battery life may vary depending on environmental conditions and number of events per day.*

Installation

Preparation

Use the provided T10 Security Torx L-Key to unscrew the security screw at the bottom of the device.

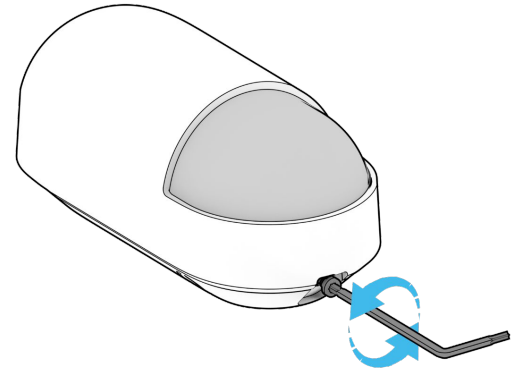

Swing the bottom of the device away from the mount plate and disengage the hook at the top of the magnet mount.

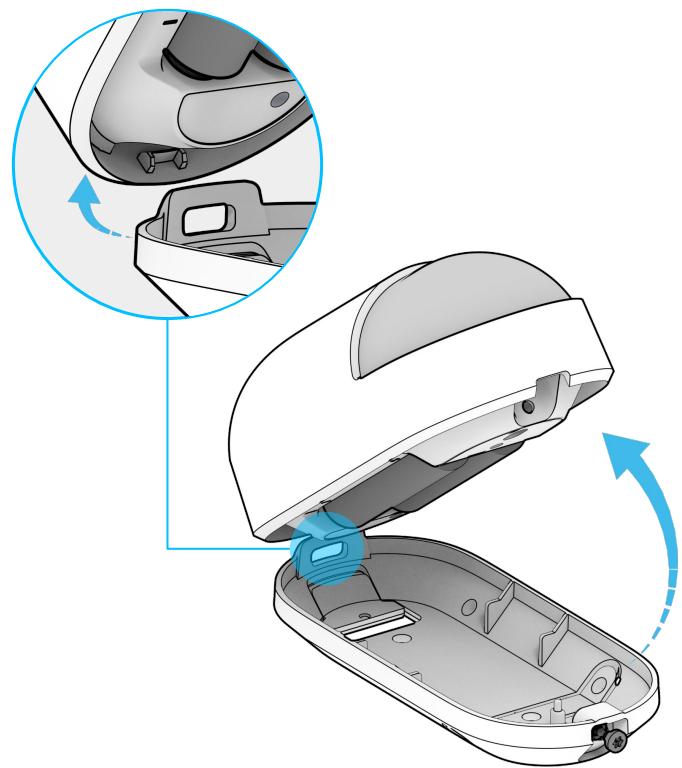

Remove the battery pull tab.



Mounting Location

The recommended position for the motion sensor is 8.2–9.8ft (2.5–3.0m) from the floor in the corner of a room. The sensor will detect motion at a range of 50ft (15m) at a 90-degree horizontal field of view.

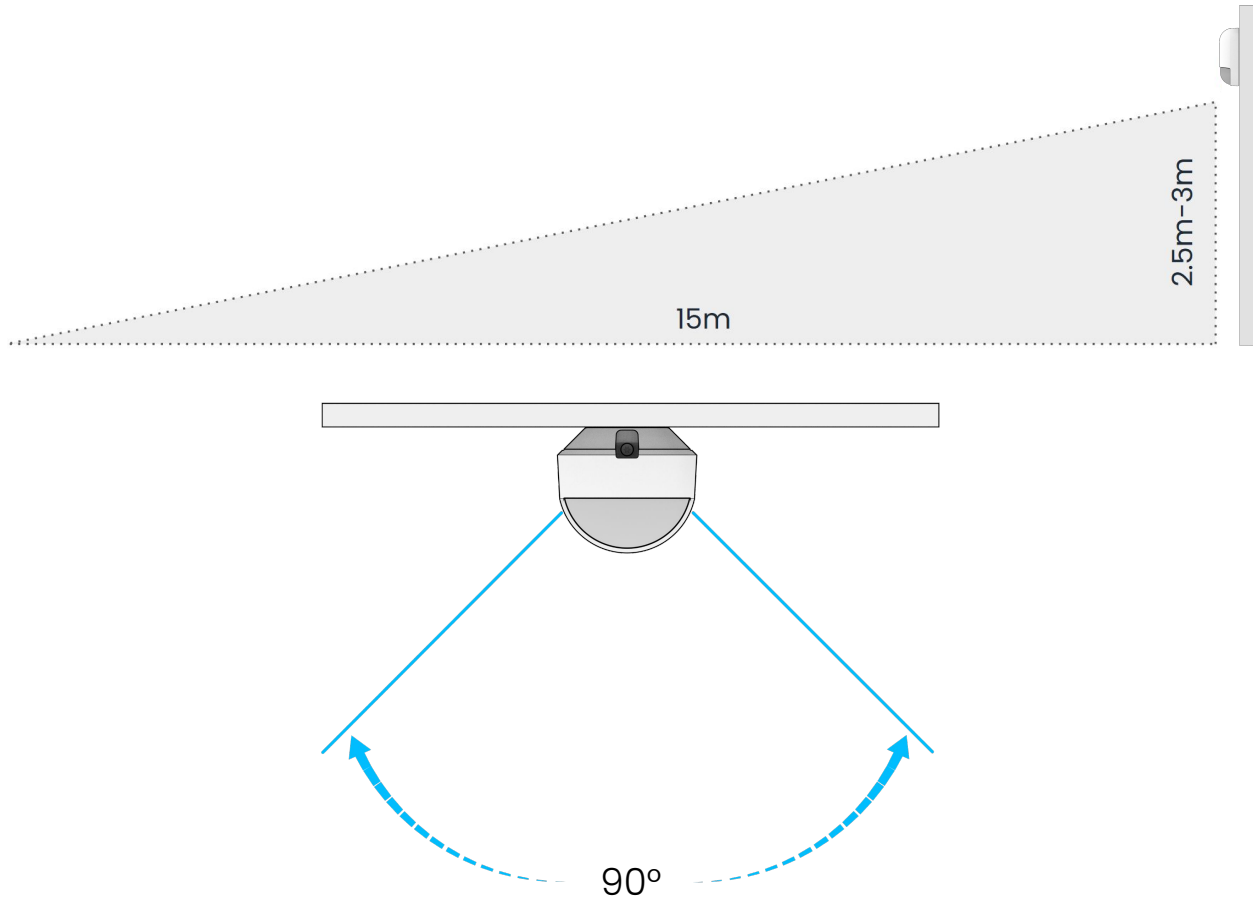

Mounting Options



Flush

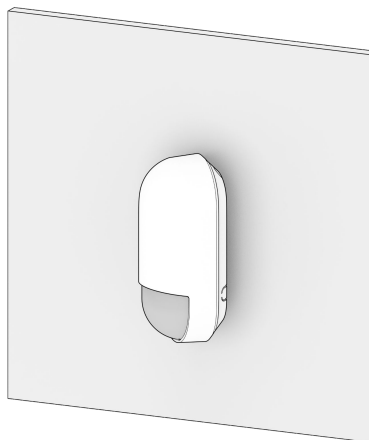

Angled

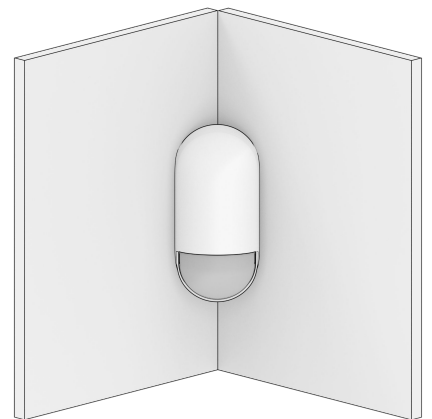

Corner

Installation

Mounting Option 1: Flush

To install the device flush against the wall, first drill two pilot holes into the divots of the mount plate.

Secure the mount plate to a flat surface using two screws.

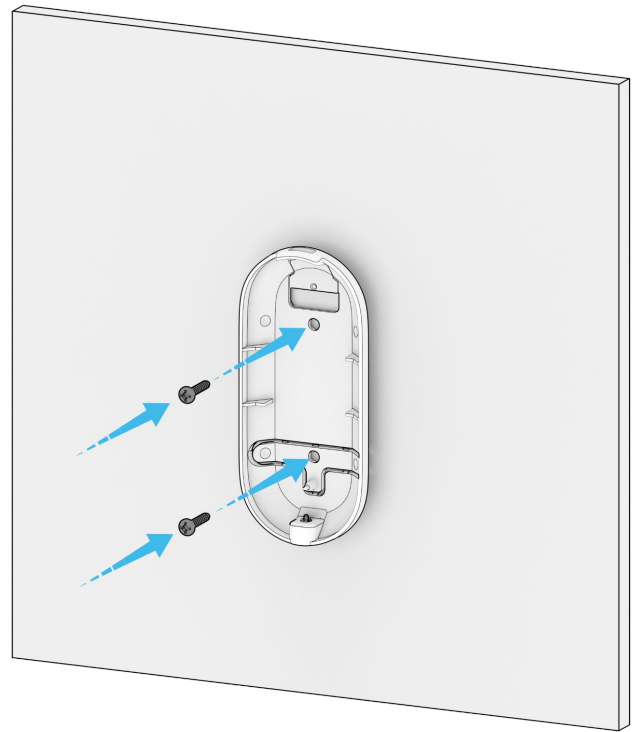

To install the device flush against the wall, first drill two pilot holes into the divots of the mount plate before driving the wall anchors through the holes.

Secure the mount plate to a flat surface using two screws.

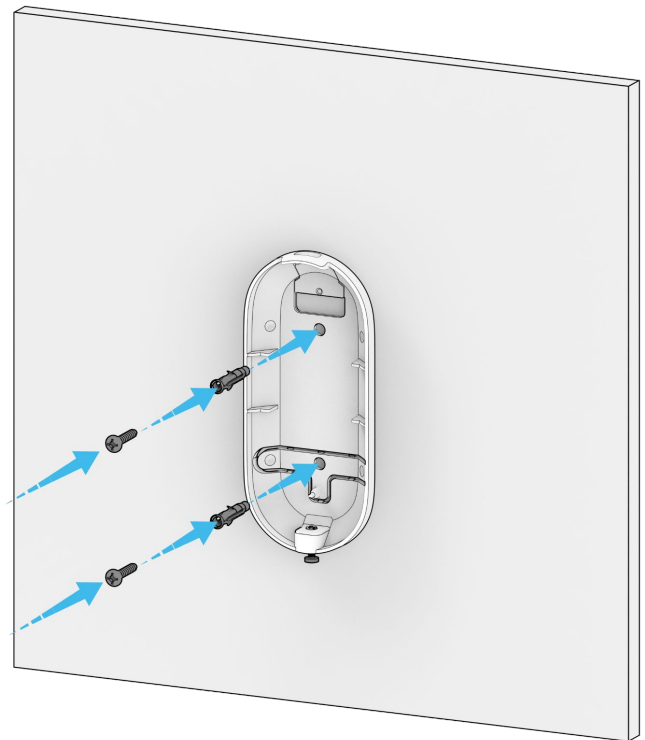

Installation

Mounting Option 2: Angled

To install the device on an angle against the wall, first drill two pilot holes into the divots of the mount plate.

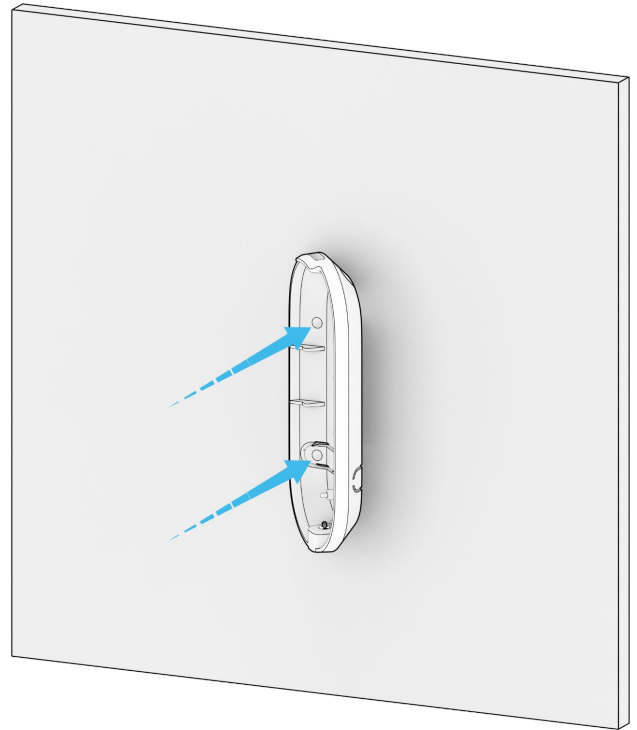

Secure the mount plate using two screws.

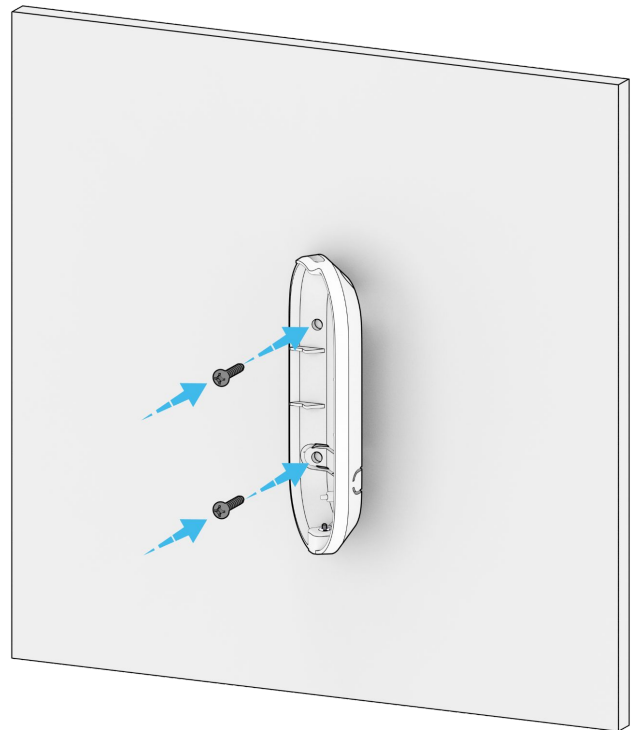

Installation

Mounting Option 3: Corner

To install the device in a corner, first drill two pilot holes into the divots of the mount plate.

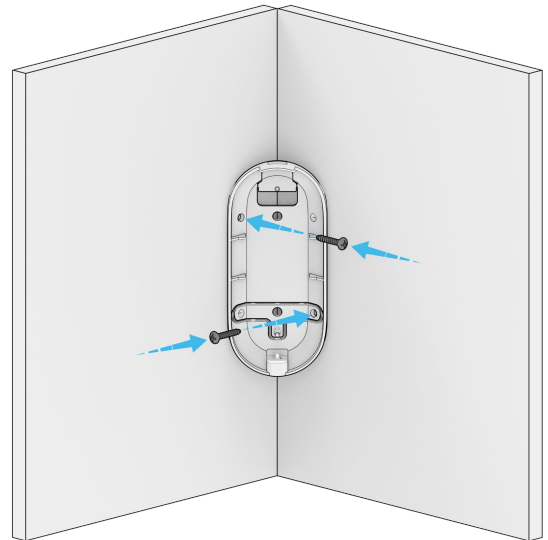
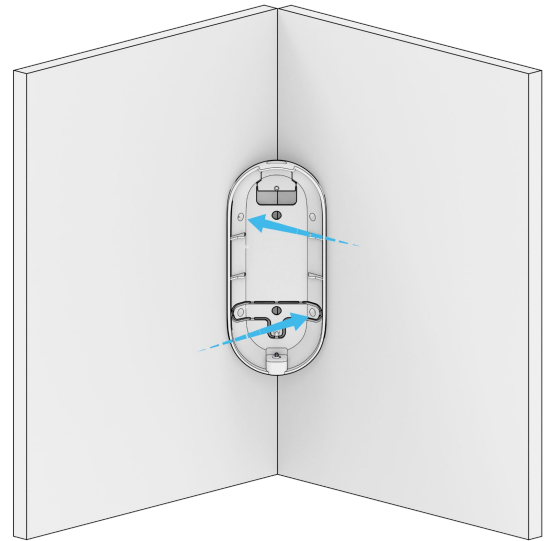

Secure the mount plate using two screws.

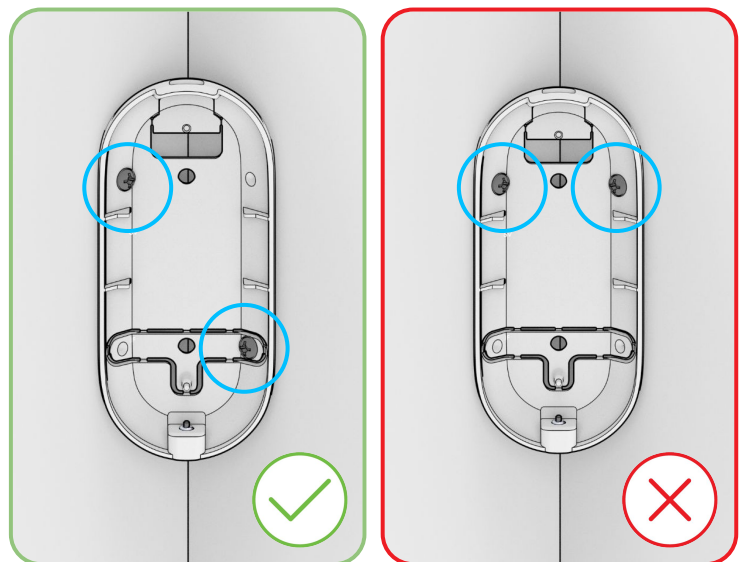

Installation

Mounting

After the mount plate is secured, engage the hook and swing the device toward the mount plate.

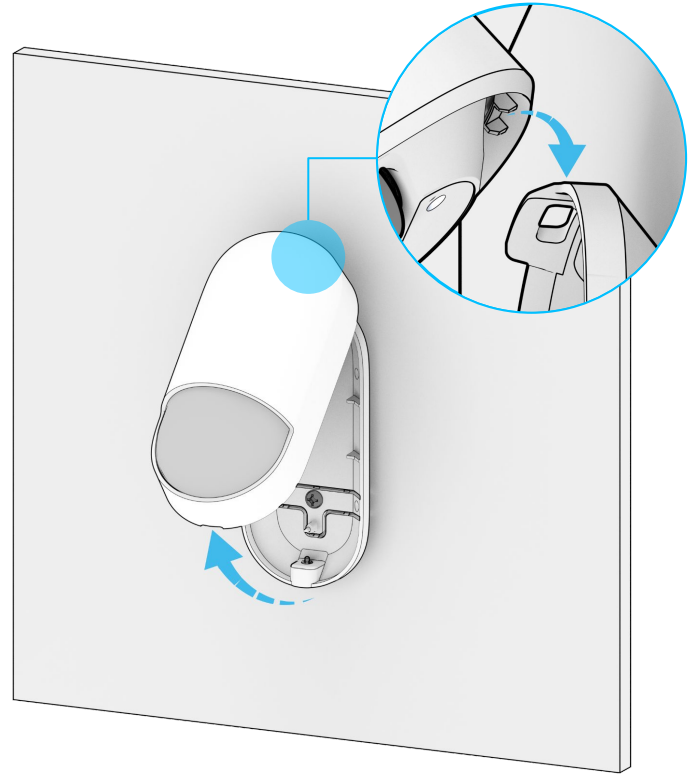

Use the provided T10 Security Torx L-Key to tighten the security screw at the bottom of the device.

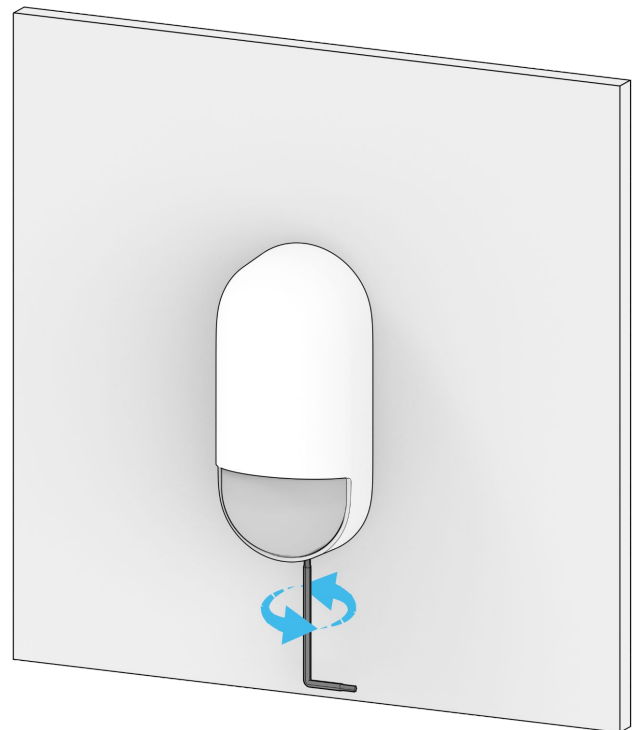

Appendix

Support

Thank you for purchasing this Verkada product. If for any reason you're experiencing issues or need assistance, please contact our 24/7 Technical Support Team immediately.

Sincerely,
The Verkada Team
verkada.com/support

